

Product group W260, Photoelectric reflex switch

WL260-R270

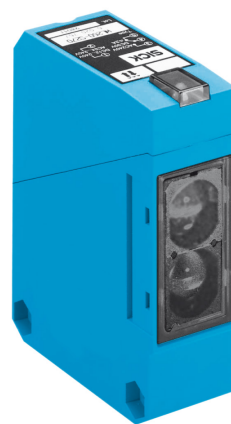

**Model Name** WL260-R270  
**Part Number** 6020768

- Universal voltage
- Polarizing filter providing reliable detection even of objects with shiny surfaces
- Terminal chamber
- Relay output, SPDT, time delays
- CE generic emission, standard CE 61000-6-3 ("Residential and Commercial Areas")



### Product features

Sensing range min ... max :	0,01 ... 15 m
Relating to :	Reflector PL80A
Sensitivity adjustment :	Potentiometer
Light source :	LED
Type of light :	visible red light
Light spot diameter :	Approx. 300 mm at 10 m distance

### Technical data

Design :	cuboid
Dimensions (W x H x D) :	25 x 78 x 63 mm
Angle of dispersion :	ca. 1.7 °
Supply voltage min ... max :	AC/DC 24 ... 240 V / 12 ... 240 V
Switching output :	Relay 1 x c/o, electrically isolated
Switching mode :	Light-switching
Power consumption :	<= 5 VA
Switching current max. :	3 A/240 V AC; 3 A/30 V DC
Response time :	<= 20 ms
Switching frequency :	25 Hz
Time delay :	OFF delay tOFF: 0.1 ... 10 s, can be connected separately

Connection type :	Cable gland
Circuit protection :	Vs connections reverse-polarity protected / Interference suppression
Enclosure rating :	IP 67
Ambient operation temperature, min ... max :	-25 °C ... +55 °C
Ambient storage temperature, min ... max :	-40 °C ... +70 °C
Weight :	ca. 120 g
Front screen heating :	-
Polarisation filter :	✓
Housing material :	ABS
Included with delivery :	Mounting bracket BEF-W260 and reflector P250

## Dimensional drawing

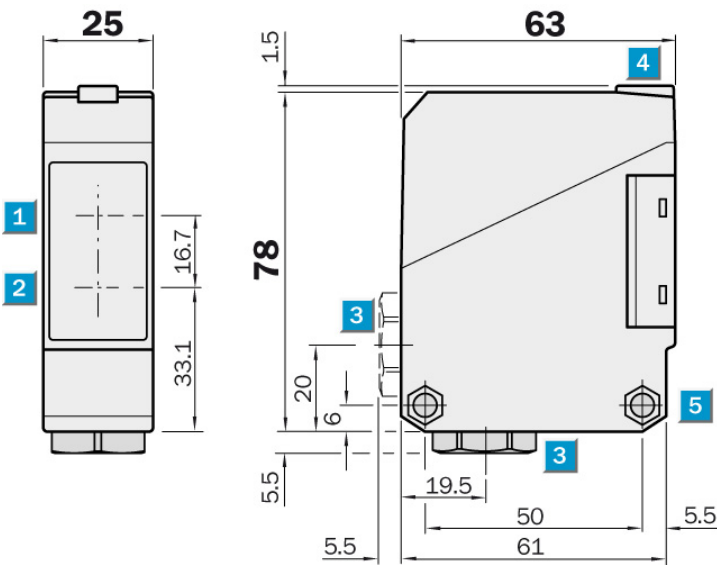

## Adjustment possible

---

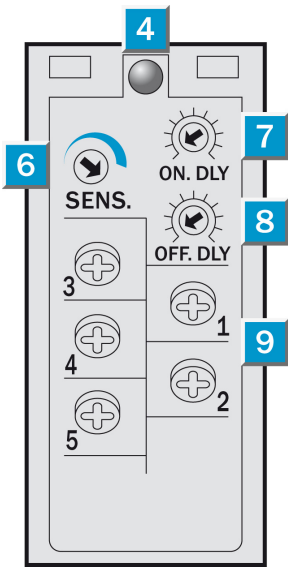

## Connection type

---

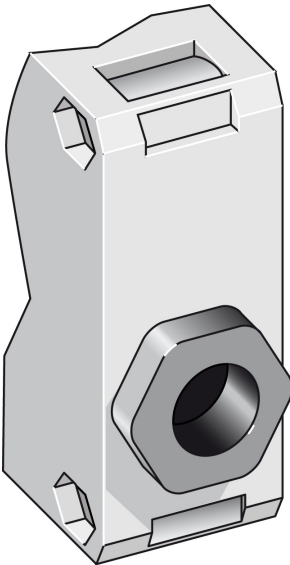

## Connection diagram

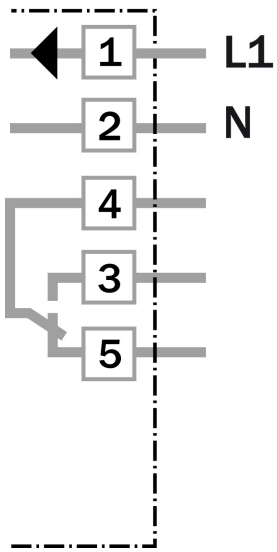

## Operating reserve

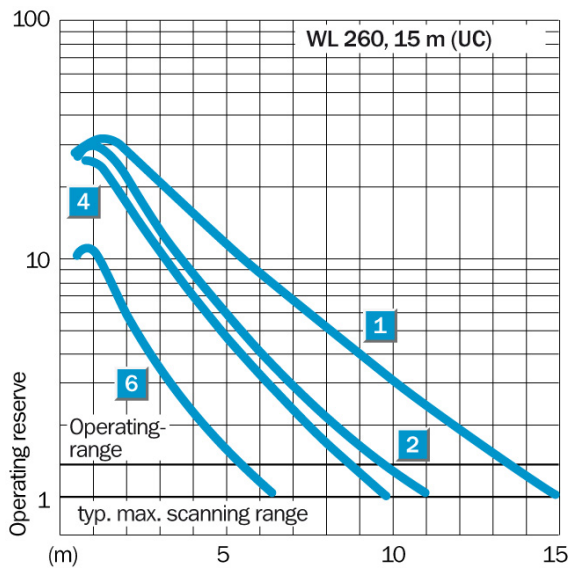

# Sensing range diagram

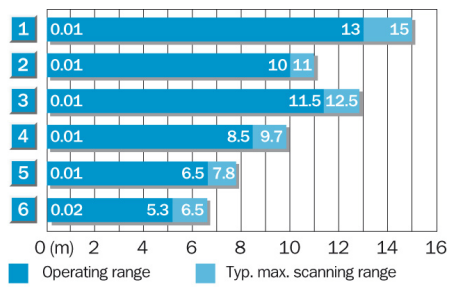

Reflector type	Operating range
1 PL 80 A	0.01 ... 13.0 m
2 P 250	0.01 ... 10.0 m
3 PL 50 A or PL 40 A	0.01 ... 11.5 m
4 PL 30 A or PL 31 A	0.01 ... 8.5 m
5 PL 20 A	0.01 ... 6.5 m
6 Reflective tape Diamond Grade	0.02 ... 5.3 m

**Australia**

Phone +61 3 9497 4100  
1800 33 48 02 – tollfree  
E-Mail sales@sick.com.au

**Belgium/Luxembourg**

Phone +32 (0)2 466 55 66  
E-Mail info@sick.be

**Brasil**

Phone +55 11 3215-4900  
E-Mail sac@sick.com.br

**Ceská Republika**

Phone +420 2 57 91 18 50  
E-Mail sick@sick.cz

**China**

Phone +852-2763 6966  
E-Mail ghk@sick.com.hk

**Danmark**

Phone +45 45 82 64 00  
E-Mail sick@sick.dk

**Deutschland**

Phone +49 211 5301-0  
E-Mail info@sick.de

**España**

Phone +34 93 480 31 00  
E-Mail info@sick.es

**France**

Phone +33 1 64 62 35 00  
E-Mail info@sick.fr

**Great Britain**

Phone +44 (0)1727 831121  
E-Mail info@sick.co.uk

**India**

Phone +91-22-4033 8333  
E-Mail info@sick-india.com

**Israel**

Phone +972-4-999-0590  
E-Mail info@sick-sensors.com

**Italia**

Phone +39 02 27 43 41  
E-Mail info@sick.it

**Japan**

Phone +81 (0)3 3358 1341  
E-Mail support@sick.jp

**Nederlands**

Phone +31 (0)30 229 25 44  
E-Mail info@sick.nl

**Norge**

Phone +47 67 81 50 00  
E-Mail austefjord@sick.no

**Österreich**

Phone +43 (0)22 36 62 28 8-0  
E-Mail office@sick.at

**Polska**

Phone +48 22 837 40 50  
E-Mail info@sick.pl

**Republic of Korea**

Phone +82-2 786 6321/4  
E-Mail kang@sickkorea.net

**Republika Slovenija**

Phone +386 (0)1-47 69 990  
E-Mail office@sick.si

**România**

Phone +40 356 171 120  
E-Mail office@sick.ro

**Russia**

Phone +7 495 775 05 34  
E-Mail info@sick-automation.ru

**Schweiz**

Phone +41 41 619 29 39  
E-Mail contact@sick.ch

**Singapore**

Phone +65 6744 3732  
E-Mail admin@sicksgp.com.sg

**Suomi**

Phone +358-9-25 15 800  
E-Mail sick@sick.fi

**Sverige**

Phone +46 10 110 10 00  
E-Mail info@sick.se

**Taiwan**

Phone +886 2 2375-6288  
E-Mail sickgrc@ms6.hinet.net

**Türkiye**

Phone +90 216 587 74 00  
E-Mail info@sick.com.tr

**United Arab Emirates**

Phone +971 4 8865 878  
E-Mail info@sick.ae

**USA/Canada/México**

Phone +1(952) 941-6780  
1 800-325-7425 – tollfree  
E-Mail info@sickusa.com

More representatives and agencies  
in all major industrial nations at  
[www.sick.com](http://www.sick.com)